

jane denham
REAL ESTATE GROUP



6-500 Crown Isle Drive



6 - 500 CROWN ISLE DRIVE

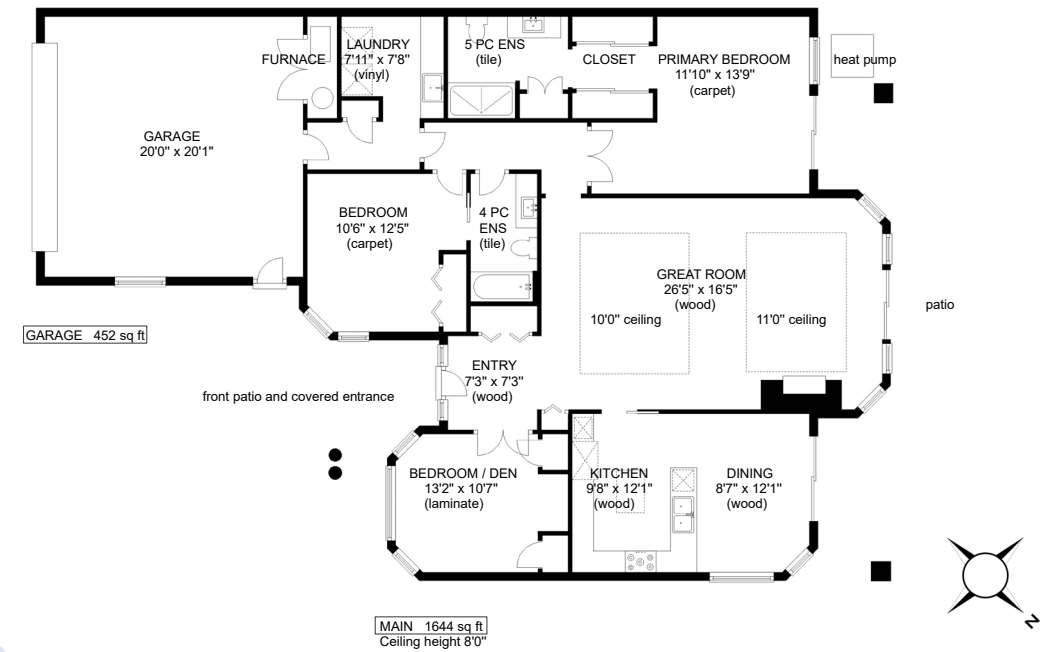

jane denham
REAL ESTATE GROUP

Prepared for the exclusive use of Jane Denham
RE/MAX Ocean Pacific Realty
250-898-1220
Measurements on the plans are intended for visual reference purposes only and should be verified

Clearview Floor Plans
250 - 331 - 2564

Welcome to '500 Crown Isle Drive'...

Welcome to '500 Crown Isle Drive'. On a private cul-de sac, this prestigious patio home development is only steps to Crown Isle's Platinum rated Golf Course and clubhouse, shopping, Costco, Starbucks, and the new Hospital. Architecturally designed & thoughtfully renovated in 2021-2023, this southwest facing one level patio home, 2 BD/ 2 BA, 1,644 sf, offers 11' entry, vaulted ceilings & transom windows embracing an abundance of natural light. Fully renovated contemporary kitchen in 2021, with s/s appliances, induction range, quartz counters, solid slab backsplash, and skylight overhead. Spacious Great room with new gas fireplace, vaulted ceilings, oak flooring and designated space for media or dining area. Double French door access to the primary bedroom with new carpets, new closet doors, stunning ensuite w/ tile flooring, quartz C/ Top vanity, fully tiled, frameless glass shower. H/W tank 2023, Heat Pump 2021, new elect panel 2021, EV charger R/in, LED lighting, window coverings 2021.



jane denham
REAL ESTATE GROUP

6-500 Crown Isle Drive | Listed at \$899,000

MLS #: 936080 | 2 Bedrooms | 2 Bathrooms

Total SqFt: 1,644

Garages: 2

Year Built: 1993

Zoning: CD-1B

Strata Fees: \$611 /mo

Please use the link below for more information:

www.janedenham.com



c 250.898.1220
jane@janedenham.com
www.janedenham.com

Grace Denham-Clare
c 250.897.8890
grace@janedenham.com



RE/MAX[®]

ocean pacific realty

Each Office Independently Owned and Operated

b 250.339.2021
tf 888.829.7205
282 Anderton Rd.
Comox BC V9M 1Y2